

**COST-EFFECTIVE ALTERNATES FOR COLUMN CAPS**

These show cost-effective alternatives for replacing special column caps by using a combination of connectors. The drawings below give beam height requirements. For design loads, consult the current *Connectors for Wood Construction* catalog.

**CCT Column Cap Alternatives**

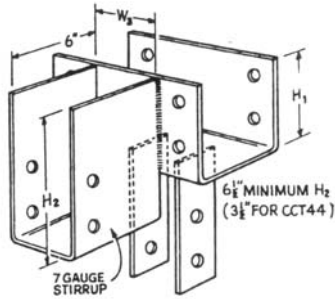

**CCT**

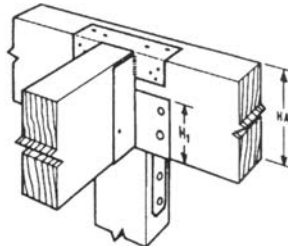

$HA \text{ min} = H1 + 2\frac{1}{2}''$

**OPTION 1: CC + HW**

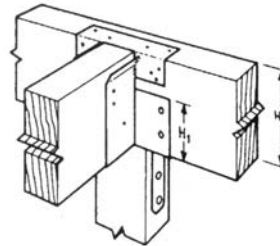

$HA \text{ min} = H1 + 2\frac{7}{8}''$

**OPTION 2: CC + GLT**

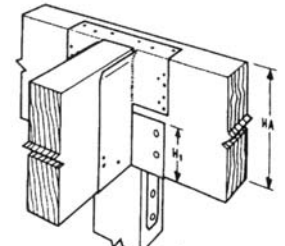

$HA \text{ min} = H1 + 6\frac{3}{4}''$

**OPTION 3: CC + HGLT**

**ECCL/R Column Cap Alternatives**

See the *Connectors for Wood Construction* catalog for Top Flange Hanger Options.

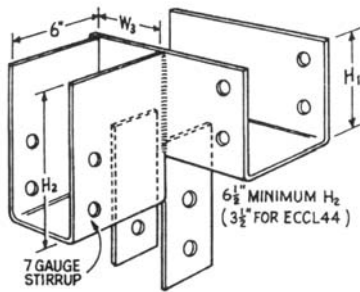

**ECCL**

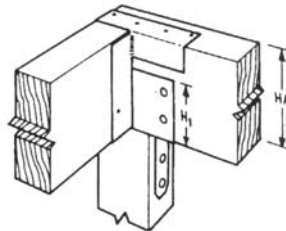

$HA \text{ min} = H1 + 2\frac{1}{2}''$

**OPTION 1: ECC + HW  
(Offset Top Flange)**

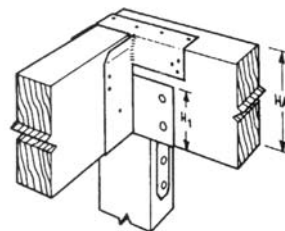

$HA \text{ min} = H1 + 2\frac{7}{8}''$

**OPTION 2: ECC + GLT  
(Offset Top Flange)**

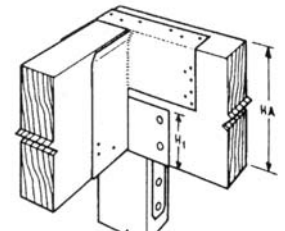

$HA \text{ min} = H1 + 6\frac{3}{4}''$

**OPTION 3: ECC + HGLT  
(Offset Top Flange)**

**CCC Column Cap Alternatives**

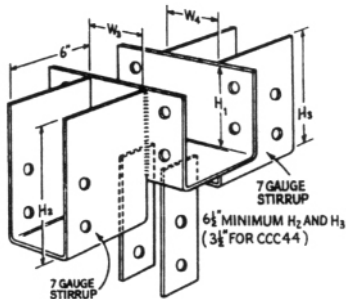

**CCC**

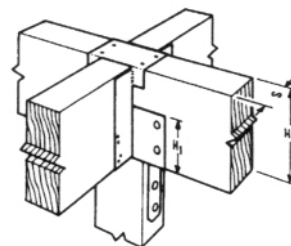

$HA \text{ min} = H1 + 2\frac{1}{2}''$

**OPTION 1: CC + HWD  
(Saddle Hanger)**

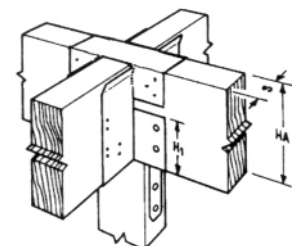

$HA \text{ min} = H1 + 4''$

**OPTION 2: CC + GLS  
(Saddle Hanger)**

Contact Simpson for current information and limited warranty or see [www.strongtie.com](http://www.strongtie.com).

**Home Office**  
5956 W Las Positas Blvd.  
Pleasanton, CA 94588  
FAX: 925/847-1603

**Southwest USA**  
260 N. Palm Street  
Brea, CA 92821  
FAX: 714/871-9167

**Southeast USA**  
2221 Country Lane  
McKinney, TX 75069  
FAX: 972/542-5379

**Eastern Canada**  
5 Kenview Blvd.  
Brampton, ON L6T 5G5  
FAX: 905/458-7274

**Warehouses:**  
Enfield, CT  
High Point, NC  
Jacksonville, FL  
Langley, BC

**Northwest USA**  
5151 S. Airport Way  
Stockton, CA 95206  
FAX: 209/234-3868

**Northeast USA**  
2600 International Street  
Columbus, OH 43228  
FAX: 614/876-0636

**Quik Drive Factory**  
436 Calvert Drive  
Gallatin, TN 37066  
FAX: 615/451-9806

**Western Canada**  
11476 Kingston St.  
Maple Ridge, BC V2X 0Y5  
FAX: 604/465-0297

**Specials Factories:**  
Eagan, MN  
Kent, WA

**800-999-5099**  
[www.strongtie.com](http://www.strongtie.com)

© 2006 Simpson Strong-Tie Company, Inc.

Printed in the USA

T-CC-2 9/06