

RAISED FLOOR BLOCKING

- Install 1 1/4" to 1 1/2" Rim Joist per plan.
- Minimum length of rim at Strong-Wall® panel to be 10' or fasten end of rim joist to perpendicular framing with two A35 each end.
- Use Simpson Strong-Tie® LTP4 to transfer shear from sill plate to rim joist per code (by Designer).
- Sill plate and anchorage per code (by Designer)
- Install Coupler nut onto SWAB or SSTB anchor bolt. Keep Witness Hole™ visible.
- Extend 7/8" all-thread rod up 5" min. above the floor sheathing.
- All-thread rod only supplied for connection above sill into the holddown. **Length of all-thread rod through floor system for 1st floor and 2nd floor application must be determined by builder and purchased separately.**

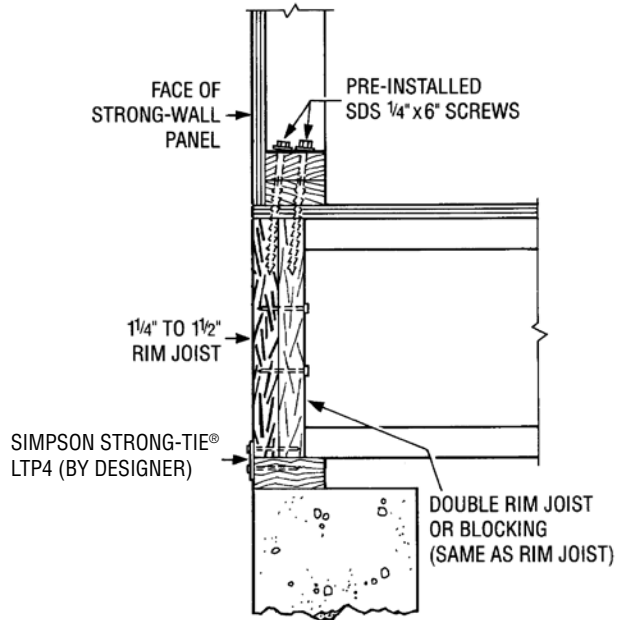

FOR JOISTS PERPENDICULAR TO RIM JOIST BELOW THE STRONG-WALL® SHEARWALL

- Attach rim material blocking between joists.
- Nail with 3 rows of 10d common nails or 16d sinkers, stagger at 3" o.c. horizontal.
- 1 nail required for each lineal inch of block (14" block requires 14 nails.)
- Provide 3 vertical squash blocks as shown below the post and bearing plate or 1 block on either side of a joist if it is under the post (cl. blocks 1/16" taller than joist.)

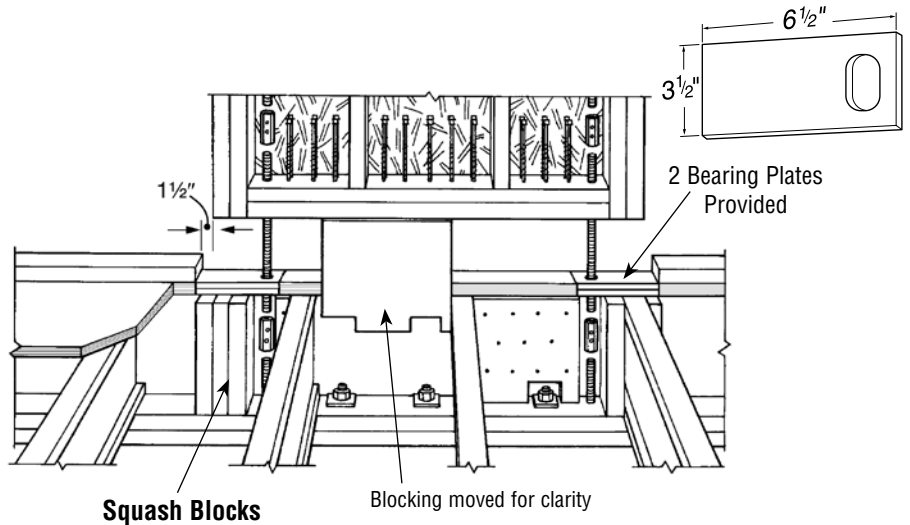

Squash Blocks

Blocking moved for clarity

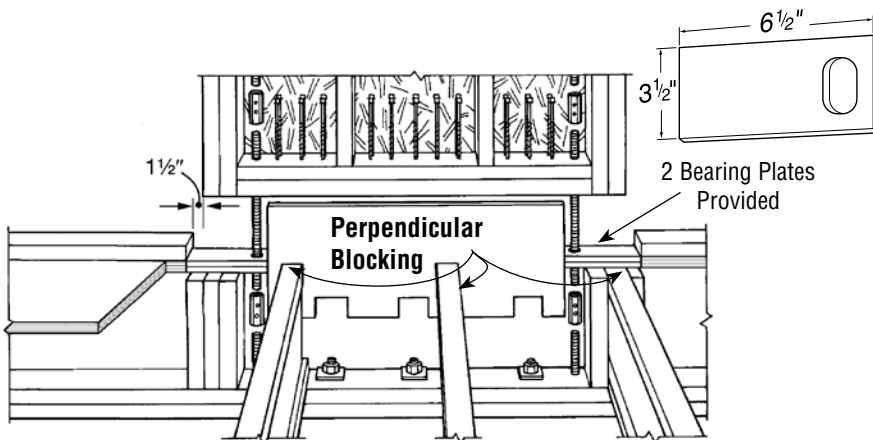

FOR JOISTS PARALLEL TO RIM JOIST BELOW THE STRONG-WALL® SHEARWALL

- Place double rim between couplers.
- Nail double rim and add squash blocks per the instructions above.
- Install perpendicular blocking minimum 24" o.c. under Strong-Wall panel. Use joist hangers if bearing length is less than code minimum.