

SINGLE WALL PORTAL

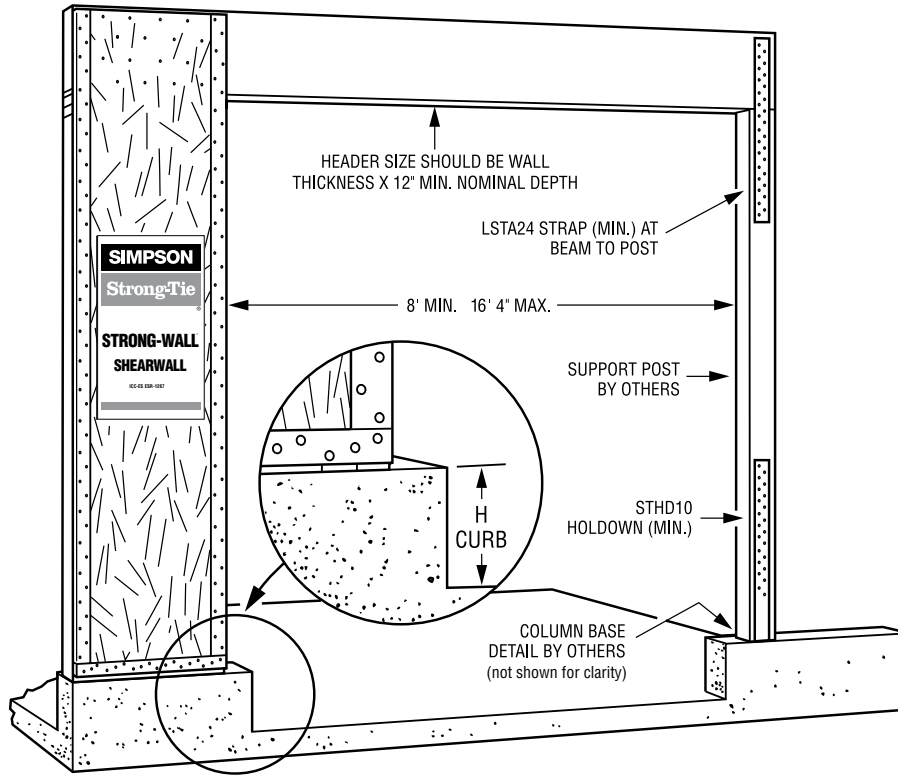

- Install Portal Strong-Wall® panel per Standard & Portal Sill and Header Connection instructions.
- STHD10 and LSTA24 (by Designer) are minimum requirements to achieve the allowable loads.
- See the current Simpson Strong-Tie® catalog for STHD10 and LSTA24 information.
- Portal walls may be installed with sheathing facing inside or outside.

GARAGE HEADER ROUGH OPENING HEIGHT

Model	H CURB	Without 1/2" Shim	With 1/2" Shim
SW16x7x4	6"	7'-0"	7'-0 1/2"
SW16x7x6	7"	7'-1"	7'-1 1/2"
SW16x8x4	6"	8'-0"	8'-0 1/2"
SW16x8x6	7"	8'-1"	8'-1 1/2"

Model	H CURB	Without 1/2" Shim	With 1/2" Shim
SW22x7x4	6"	7'-0"	7'-0 1/2"
SW22x7x6	7"	7'-1"	7'-1 1/2"
SW22x8x4	6"	8'-0"	8'-0 1/2"
SW22x8x6	7"	8'-1"	8'-1 1/2"

NOTE: Strong-Wall® Shearwalls have fixed heights. The height of the garage curb above the garage slab is critical to achieve the correct garage header rough opening height.

*One 1/2" shim is provided with Portal walls.