

# SINGLE & DOUBLE WALL PORTAL

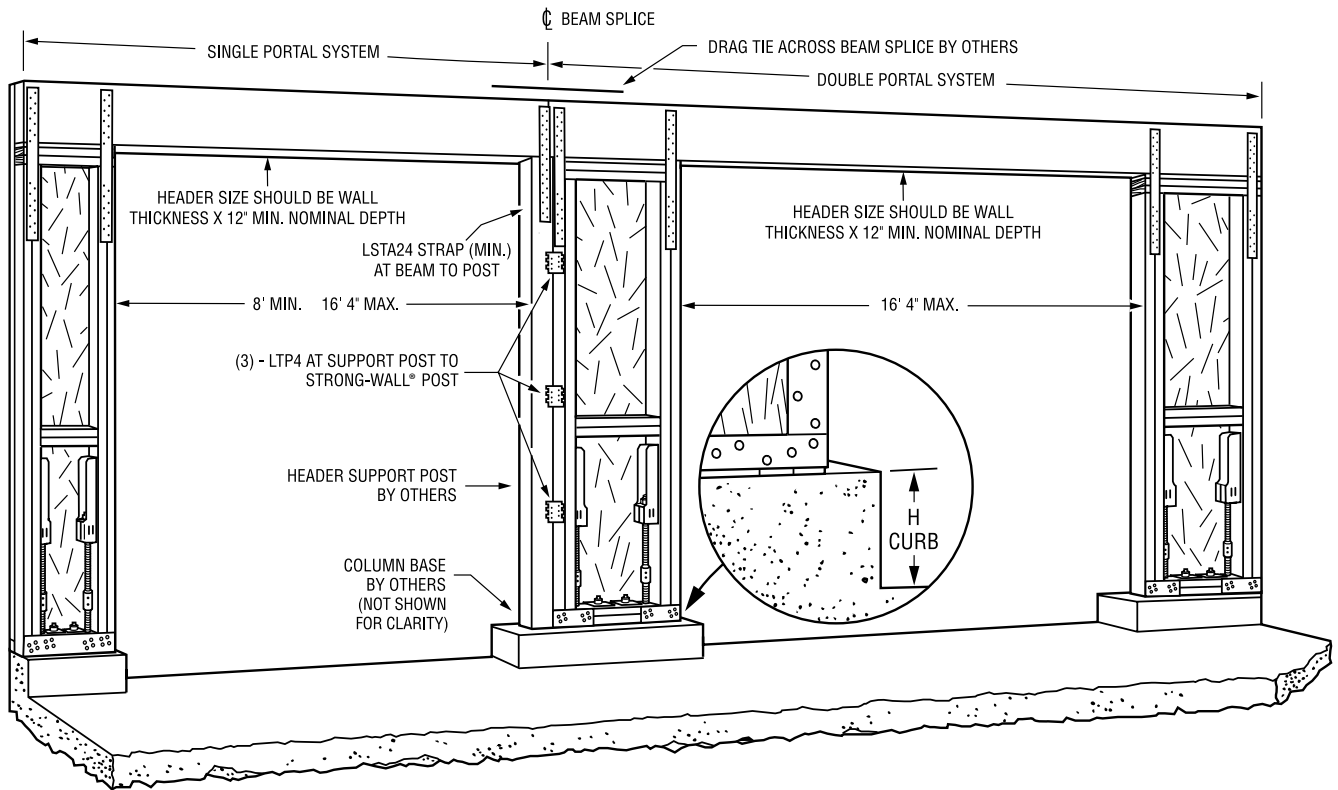

- Install Portal Strong-Wall® panel per Standard & Portal Sill Connection and Header Connection instructions.
- Header may not be spliced over the center Strong-Wall panel. Header must extend to the outside edge of the Strong-Wall panel.

- Portal walls may be installed with sheathing facing inside or outside.
- A single piece header (no camber) may be used across all 3 walls with no additional posts.
- LTP4 and LSTA24 (design by others) are minimum requirements to achieve the allowable loads.
- See the current Simpson Strong-Tie® catalog for LTP4 and LSTA24 information.

## GARAGE HEADER ROUGH OPENING HEIGHT

Model	H CURB	Without 1/2" Shim	With 1/2" Shim
SW16x7x4	6"	7'-0"	7'-0 1/2"
SW16x7x6	7"	7'-1"	7'-1 1/2"
SW16x8x4	6"	8'-0"	8'-0 1/2"
SW16x8x6	7"	8'-1"	8'-1 1/2"

Model	H CURB	Without 1/2" Shim	With 1/2" Shim
SW22x7x4	6"	7'-0"	7'-0 1/2"
SW22x7x6	7"	7'-1"	7'-1 1/2"
SW22x8x4	6"	8'-0"	8'-0 1/2"
SW22x8x6	7"	8'-1"	8'-1 1/2"

**NOTE: Strong-Wall® Shearwalls have fixed heights. The height of the garage curb above the garage slab is critical to achieve the correct garage header rough opening height.**

\*One 1/2" shim is provided with Portal walls.