

TOP FLANGE HANGERS GLS/HGLS/GLT/HGLT *Beam & Glulam Saddle Hangers*

See table on page 120. See Hanger Options on page 183 for hanger modifications, which may result in reduced loads.

GLT and HGLT accommodate typical structural requirements for timber and glulam beams. Top flange depth allows installation on minimum 4x ledger (3½" net). Funnel flanges allow easy installation of beams.

GLS and HGLS are heavy glulam saddle hangers. Tested and code-listed seismic tie provisions are added to the GLS or HGLS—order GLST or HGLST. The seismic tie models use three extra ¾" bolts through each carried member and two ¾" bolts through the supporting member. Bolt holes shall be a minimum of 1/32" to a maximum of 1/16" larger than the bolt diameter (per 10.4.1.2 CSA O86-01).

MATERIAL: See table on page 120.

FINISH: Simpson gray paint. Hot-dip galvanized available; specify HDG.

INSTALLATION: • Use all specified fasteners. See General Notes.

GLT/HGLT

- All GLTs used with sawn timbers have a 12" L dimension.
- Fasteners are included.
- GLT may be attached to steel headers by ¾" x 2½" fillet welds at each end of the header angle to obtain the tabulated loads. HGLT may be attached to steel headers by ¼" x 2½" fillet welds at each end of the header angle to obtain the tabulated factored resistances. Factored uplift resistances do not apply to this weld-on application.

GLS/HGLS

- N54A nails are included with the hangers.
- Seismic Ties—the carried member bolts should be located in the upper half of the 13/16" x 1½" slotted holes. Standard washers must be used with all bolts.
- Minimum header width for saddle hangers is 5¼".
- Factored resistances listed are per stirrup.

TO ORDER: GLS/HGLS—Specify H₁, H₂ and S dimensions (see illustrations).

OPTIONS: See Hanger Options page 183.

Model	Top Flange Ga	Stirrup Width (W)	Top Flange Length (L)
GLT	3	2½" - 5½"	10
		5¾" - 6¾"	12
HGLT	3	2½" - 8¼"	12
		8¾"	14
GLS	3	3¼"	6
		5¼"	9
		6¾"	12
HGLS	3	5¼" - 8¾"	12
		3¼"	10½"
GLST	3	5¼"	12½"
		6¾"	13¾"
		8¾"	15¾"
HGLST	3	5¼"	12½"
		6¾"	13¾"
		8¾"	15¾"

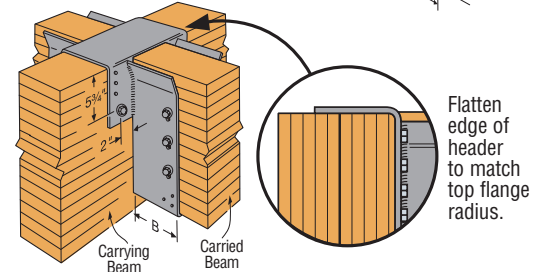
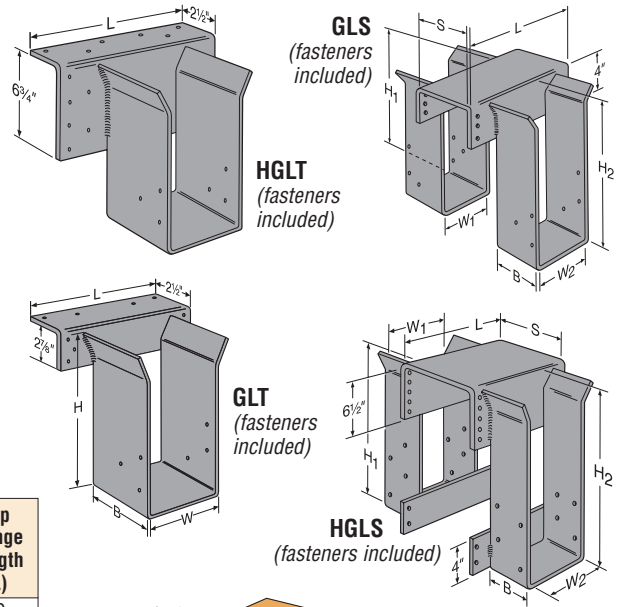

GLST Installed with Glulam Beams (HGLST similar)
When H dimension is ≤ 18", product is supplied with seismic straps. No options on GLST and HGLST.

Glulam Beam Connectors

TOP FLANGE HANGERS HHB/GB/HGB *Beam & Purlin Hangers*

See table on page 120. See Hanger Options on page 183 for hanger modifications, which may result in reduced loads.

Precision forming with manufacturing quality control provides dimensional accuracy and helps ensure proper bearing area and connection.

MATERIAL: See table on page 120.

FINISH: HHB, GB, HGB, all saddle hangers and all welded sloped and special hangers—Simpson gray paint. HHB may be ordered hot-dip galvanized; specify HDG.

INSTALLATION:

- Use specified fasteners. See General Notes and nailer table.
- HHB, GB and HGB may be used for weld-on applications. The minimum required weld to the top flanges is 1/8" x 2" fillet weld to each side of each top flange tab for 14 and 12 gauge and 3/16" x 2" fillet weld to each side of each top flange tab for 7 gauge. Distribute the weld equally on both top flanges. Welding cancels the top and face nailing requirements. Consult the code for special considerations when welding galvanized steel. The area should be well-ventilated. Weld on applications produce the maximum factored resistance listed. Uplift resistances do not apply to welded applications.
- Ledgers must be evaluated for each application separately. Check TF dimension, nail length and nail location on ledger.

OPTIONS:

- HHB—other widths are available; specify W dimension (the minimum W dimension is 2½").
- Saddle hangers are made to order; add "D" to model (e.g. HHBD3); specify S (for saddle) dimension. They may be used for most conditions except at end wall locations, and are preferred for nailer applications.
- The coating on special B hangers will depend on the manufacturing process used. Check with your Simpson Strong-Tie representative for details. Hot-dip galvanized available: specify HDG.
- B dimensions may be increased on some models.
- See Hanger Options, page 183.

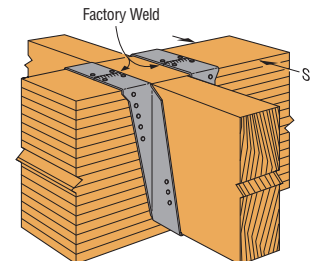

Typical HHB, GB and HGB Saddle Installation

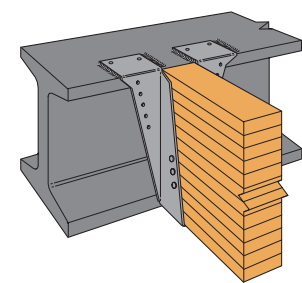

HHB, GB and HGB are acceptable for weld-on applications. See Instructions to the Installer, page 14, note m.