

GBC Gable Brace Connector



This product is preferable to similar connectors because of a) easier installation, b) higher loads, c) lower installed cost, or a combination of these features.

The GBC provides improved anchorage of gable bracing to the exterior wall. Installation flexibility for brace angle. GBC has tension and compression capacities.

MATERIAL: 16 gauge **FINISH:** Galvanized

INSTALLATION:

- Use all specified fasteners. See General Notes.
- The GBC must be installed in pairs to achieve full load capacity.

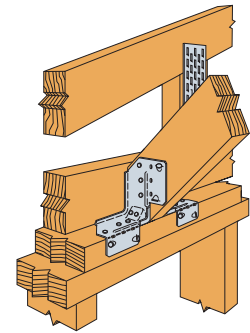
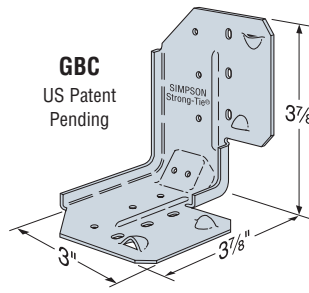

Typical GBC Installation

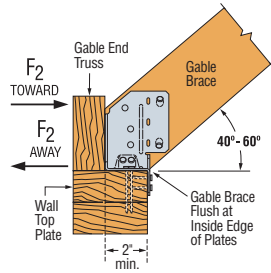

Typical Sloped Installation

Model No.	Qty Req'd	Fasteners per Connector		Perpendicular to Endwall (F ₂) Factored Resistance (K _D =1.15)							
				D.Fir-L				S-P-F			
				Toward Anchors		Away from Anchors		Toward Anchors		Away from Anchors	
				Gable Brace Angle	Gable Brace Angle	Gable Brace Angle	Gable Brace Angle	Gable Brace Angle	Gable Brace Angle	Gable Brace Angle	Gable Brace Angle
GBC	2	5-8dx1½	7-8d	40°-45°	46°-60°	40°-45°	46°-60°	40°-45°	46°-60°	40°-45°	46°-60°
				lbs	lbs	lbs	lbs	lbs	lbs	lbs	lbs
				kN	kN	kN	kN	kN	kN	kN	kN
				945	830	695	610	665	580	490	425
				4.21	3.70	3.10	2.72	2.96	2.58	2.18	1.89

- For 1¼ x 3½ (or larger) LVL gable brace, the factored resistance at 40° to 45° is 945 lbs (4.21 kN) towards the anchors and 970 lbs (4.32 kN) away from the anchors.
- Factored resistances have been increased 15% for earthquake or wind loading with no further increase allowed. Reduce where other loads govern.
- Use a minimum 2x4 gable brace.
- NAILS:** 8d = 0.131" dia. x 2½" long, 8dx1½ = 0.131" dia. x 1½" long. See page 16-17 for other nail sizes and information.

GBC INSTALLATION SEQUENCE

Slope	H Dimension
40°	2 15/16"
50°	3 1/4"
60°	3 3/4"

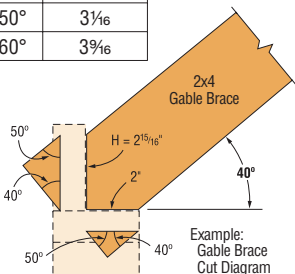

STEP 1

Double angle cut the gable brace to sit flat on the wall double top plate and flush against the gable end truss for 2x4 top plate. The double angle cuts should form a 90° angle on the end of the gable brace.

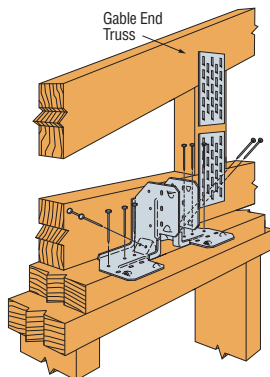

STEP 2

Set each GBC on top of the double top plate so that the bend line slots are flush with the inside edge of the double top plate. Install fasteners into the top of the double top plate.

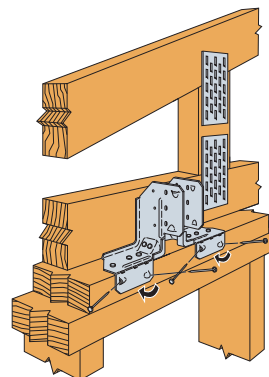

STEP 3

Bend GBC legs (one time only) over the inside of the double top plate and install fasteners.

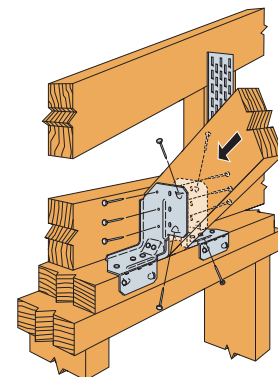

STEP 4

Install fasteners into the gable brace. NOTE: Attach the other end of the gable brace to blocking at the roof diaphragm as directed by the Designer.

TSF Truss Spacer

The TSF is a fast and accurate method for spacing trusses that eliminates layout marking of top plates and can be left in place under the sheathing. Accuracy is improved, spacing errors are minimized, and it is easy to use.

MATERIAL: 24 gauge

FINISH: Galvanized

INSTALLATION:

- See Installation Sequence below.
- TSF Truss Spacers do not provide bracing of any kind and are not structural members. The TSF is for spacing only. Refer to instructions from architect, engineer, truss manufacturer or other for bracing and installation information.

Model No.	Dimensions		
	W	O.C. Spacing	Total Length
TSF2-16	1½"	16"	8'
TSF2-24	1½"	24"	10'

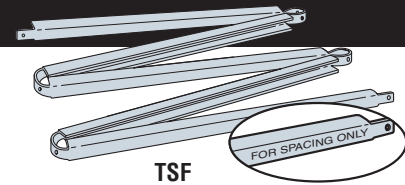

TSF

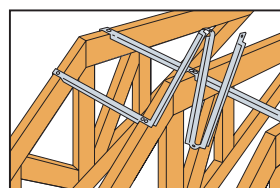

STEP 1

Nail starting notch to first member.

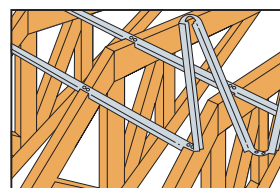

STEP 2

As each successive member is positioned, unfold TSF to next notch. The notch teeth grip member and align it for nailing.

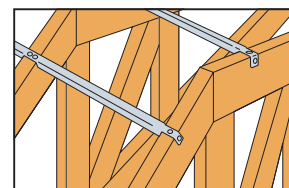

STEP 3

If spacer does not align with end truss, break spacer off at notch. Then, hammer spacer flat, fold it under and nail.