

# STEEL STRONG-WALL®: Installation Details

DRILL 2" DIAMETER x 1" DEEP HOLE OR NOTCH 2"x2"x1" DEEP MAX. IN SHEATHING & RIM JOIST. SET LOWER NUT FLUSH WITH TOP OF SHEATHING. STEEL STRONG-WALL BASE PLATE SHALL SIT FLUSH & LEVEL ON NUTS.

PLACE STEEL STRONG-WALL® PANEL OVER THREADED RODS AND SECURE WITH HEAVY HEX NUTS (PROVIDED). USE 1 1/4" WRENCH/SOCKET FOR 3/4" NUT 1 5/8" WRENCH/SOCKET FOR 1" NUT. NUTS SHALL BE SNUG TIGHT. DO NOT USE AN IMPACT WRENCH.

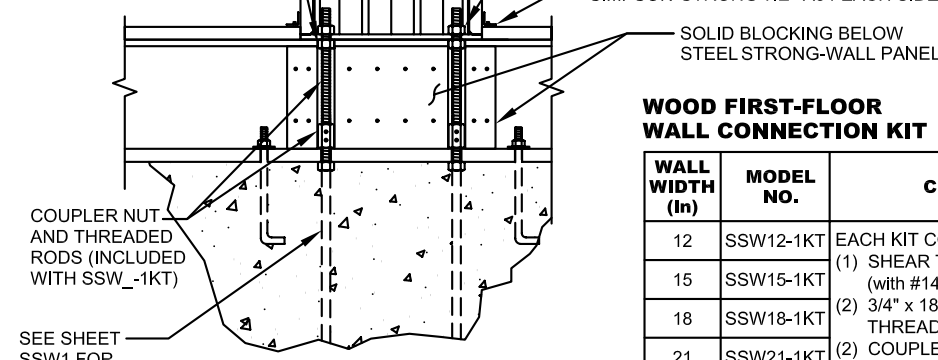

COUPLER NUT AND THREADED RODS (INCLUDED WITH SSW\_-1KT)

SEE SHEET SSW1 FOR ANCHORAGE SOLUTIONS.

**INTERIOR ELEVATION**

**WOOD FIRST-FLOOR WALL CONNECTION KIT**

WALL WIDTH (In)	MODEL NO.	CONTENTS
12	SSW12-1KT	EACH KIT CONTAINS: (1) SHEAR TRANSFER PLATE (with #14 SCREWS)
15	SSW15-1KT	(2) 3/4" x 18" OR 1" x 18" THREADED RODS (ASTM A36)
18	SSW18-1KT	(2) COUPLER NUTS
21	SSW21-1KT	(2) HEAVY HEX NUTS
24	SSW24-1KT	INSTALLATION INSTRUCTIONS

ORDER FIRST FLOOR CONNECTOR KIT SEPARATELY. MODEL SSW\_-1KT . EXAMPLE: SSW21-1KT

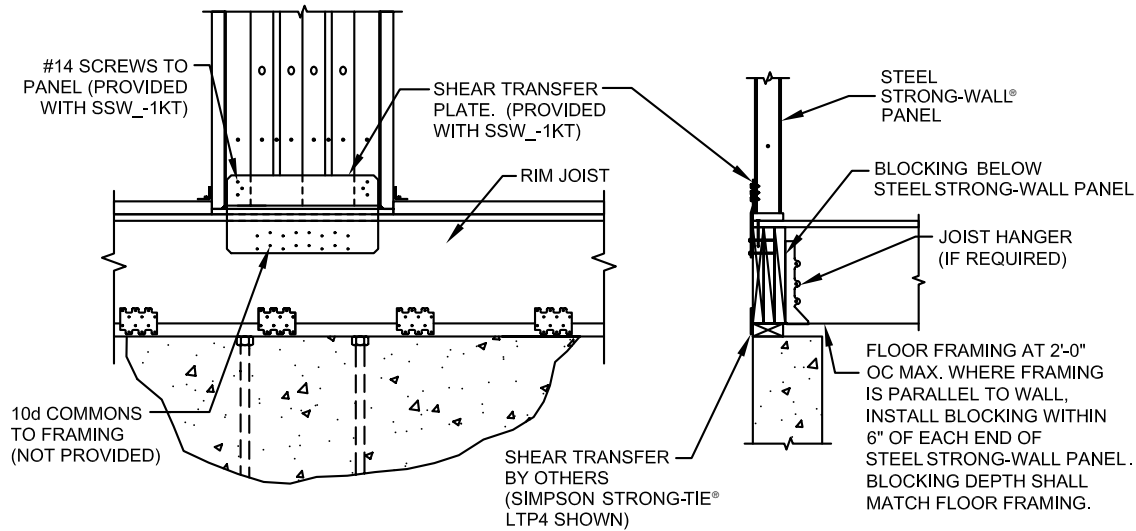

#14 SCREWS TO PANEL (PROVIDED WITH SSW\_-1KT)

SHEAR TRANSFER PLATE. (PROVIDED WITH SSW\_-1KT)

RIM JOIST

10d COMMONS TO FRAMING (NOT PROVIDED)

SHEAR TRANSFER BY OTHERS (SIMPSON STRONG-TIE® LTP4 SHOWN)

STEEL STRONG-WALL® PANEL

BLOCKING BELOW STEEL STRONG-WALL PANEL



JOIST HANGER (IF REQUIRED)

FLOOR FRAMING AT 2'-0" OC MAX. WHERE FRAMING IS PARALLEL TO WALL, INSTALL BLOCKING WITHIN 6" OF EACH END OF STEEL STRONG-WALL PANEL. BLOCKING DEPTH SHALL MATCH FLOOR FRAMING.

**EXTERIOR ELEVATION**

**SECTION**

**FIRST FLOOR AT WOOD FRAMING NOTES:**

1. USE WOOD FIRST-FLOOR ALLOWABLE LOAD TABLES FOR THIS INSTALLATION.
2. USE ALTERNATE DETAIL  TO ACHIEVE MAXIMUM ON CONCRETE ALLOWABLE LOADS.
3. FOR TWO-STORY STACKED STEEL STRONG-WALLS WITH WOOD FIRST FLOOR, USE ALTERNATE DETAIL .
4. REGISTERED DESIGN PROFESSIONAL SHALL DESIGN FOR SHEAR TRANSFER FROM RIM JOIST TO SILL PLATE AND SILL PLATE TO FOUNDATION.

REGISTERED DESIGN PROFESSIONAL IS PERMITTED TO MODIFY DETAILS FOR SPECIFIC CONDITIONS.