

S/HTC Heavy Truss Clips

S/HTC provides a slotted connection from the truss or joist to the top track when isolation of two members is required.

MATERIAL: 43 mil (18 ga)

FINISH: Galvanized

INSTALLATION: • Use all specified fasteners.

- Screws in vertical slots shall not be driven completely flush against the connector when vertical movement is desired

CODES: See page 8 for Code Listing Key Chart.

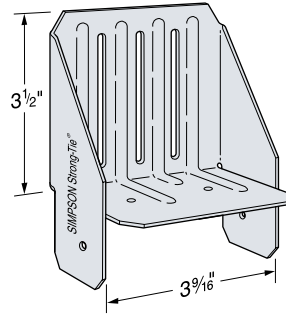

S/HTC4

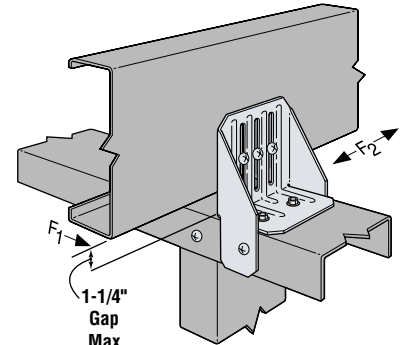

Typical S/HTC4 Installation

Model No.	Fasteners		Allowable Loads 43 mil (18 ga)				Code Ref.
	Top Track	Truss	Without Gap ¹		With 1 1/4" Gap ²		
			F ₁	F ₂	F ₁	F ₂	
S/HTC4	4 - #8	3 - #8	320	460	85	175	FC1

1. Truss or rafter must be bearing on top plate to achieve the allowable loads under "WITHOUT GAP."
2. Installed with maximum 1 1/4" space between rafter or truss and top plate under "WITH 1 1/4" GAP." Where loads are not required, space is not limited to 1 1/4" .

Truss Connectors

Straps & Ties

LTS/MTS/HTS Twist Straps

Twist straps provide a tension connection between two members. They resist uplift at the heel of a truss economically. The 3" bend section eliminates interference at the transition points between steel members.

MATERIAL: See table

FINISH: Galvanized. Some products available in stainless steel and ZMAX[®]; see Corrosion Information, page 12–13.

INSTALLATION: Use all specified fasteners. See General Notes.

CODES: See page 8 for Code Listing Key Chart.

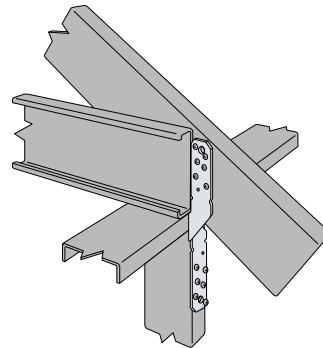

Typical MTS Installation Truss to Steel Studs

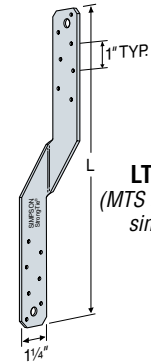

LTS12
(MTS and HTS similar)

Available with additional corrosion protection. Check with Simpson Strong-Tie.

Model No.	Connector Material Thickness mil (ga)	L	Fasteners (Total)			Allowable Tension Loads	Code Ref.
			Rafter/Stud/Joist Thickness				
			33 mil (20 ga)	43 mil (18 ga)	54 mil (16 ga)		
LTS12	43 (18 ga)	12	10-#10	6-#10	6-#10	775	ILC1, LC1, FC1
LTS16		16	10-#10	6-#10	6-#10	775	
LTS18		18	10-#10	6-#10	6-#10	775	
LTS20	54 (16 ga)	20	10-#10	6-#10	6-#10	775	ILC1, LC1, FC1
MTS12		12	12-#10	8-#10	6-#10	995	
MTS16		16	12-#10	8-#10	6-#10	995	
MTS18		18	12-#10	8-#10	6-#10	995	
MTS20		20	12-#10	8-#10	6-#10	995	
MTS30		30	12-#10	8-#10	6-#10	995	
MTS24C		24	12-#10	8-#10	6-#10	995	
MTS30C		30	12-#10	8-#10	6-#10	995	
HTS16		68 (14 ga)	16	16-#10	12-#10	6-#10	
HTS20	20		18-#10	12-#10	6-#10	1450	
HTS24	24		18-#10	12-#10	6-#10	1450	
HTS28	28		18-#10	12-#10	6-#10	1450	
HTS30	30		18-#10	12-#10	6-#10	1450	
HTS30C	30		18-#10	12-#10	6-#10	1450	

1. Not all fastener holes need to be filled as additional fastener holes are provided. Install fasteners symmetrically.
2. Install half of the fasteners on each end of strap to achieve full loads.
3. All straps except the MTS30 and HTS30 have the twist in the center of the strap.
4. Twist straps do not have to be wrapped over the truss to achieve the load.
5. May be installed on the inside face of the stud.

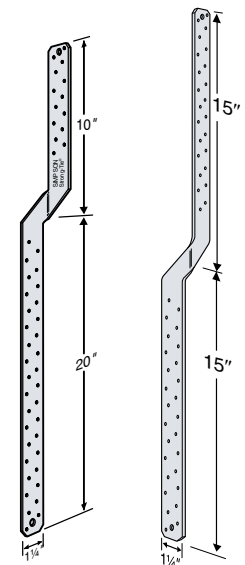

MTS30
(HTS30 similar)

MTS30C
(HTS30C similar)