

Anchorage

The Strong Frame™ ordinary moment frame also simplifies anchorage:

- **Streamlined footing design:** Pre-engineered anchorage solutions simplify the design process. No more tedious anchor calculations, just select the solution that fits your footing geometry and you are done.
- **Two pre-engineered anchorage options available:** The OMFSL anchorage assembly places the frame flush with the edge of concrete allowing it to fit into a standard 2x6 wall without bump-outs or furring. The OMFAB tied-anchorage assembly is designed for use where a 2x8 wall is acceptable.
- **Pre-assembled anchor-bolt assemblies:** Anchor bolts are pre-assembled on a template that mounts on the form. This helps ensure correct anchor placement for trouble-free installation of columns.
- **Field flexibility to address anchor location issues:** Connections can be shimmed to provide up to ½" of adjustment when anchor bolts are misaligned.
- **Reusable layout tool for reliable anchor location:** Optional Universal Template Locator (UTL) allows precise placement of anchor-bolt assemblies for both columns, helping to ensure correct positioning.
- **Post-installed anchorage solutions available for prescriptive applications:** Simpson Strong-Tie® adhesive anchor solutions as well as the Simpson Strong-Tie Titen HD® screw anchor for prescriptive applications.



Strong Frame™ OMFSL anchorage assemblies make design and installation faster and easier.

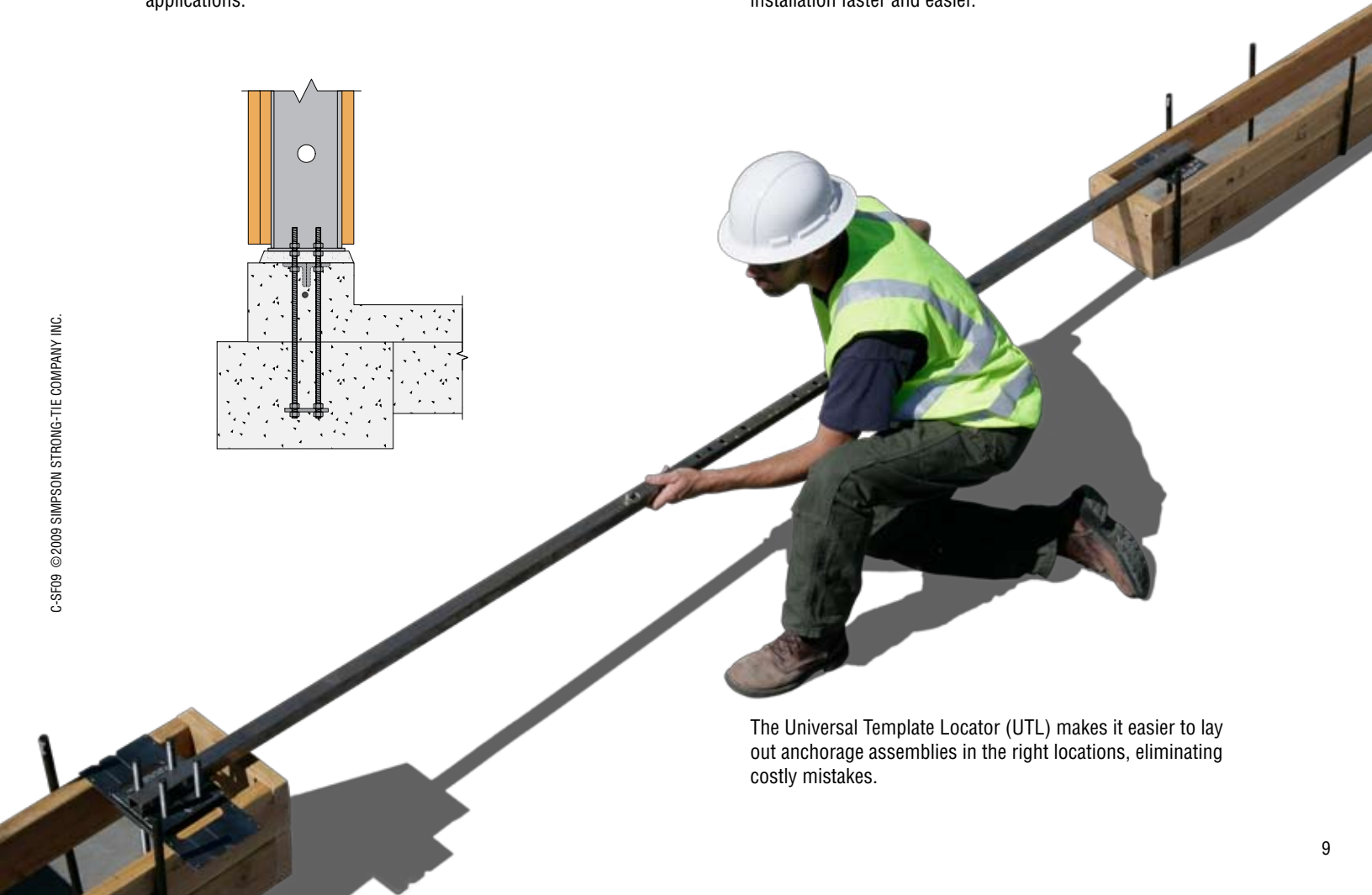
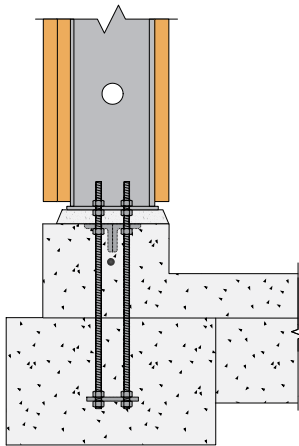

The Universal Template Locator (UTL) makes it easier to lay out anchorage assemblies in the right locations, eliminating costly mistakes.