

Wall Bracing *Wind Solutions for Stemwall Foundations (Anchorage into Wall)*

| Equivalent Wall Bracing Length (ft) | Nominal Frame Width (ft) | Model No. | Minimum ¹¹ Footing Width, W (in) | Minimum ¹¹ Footing Depth, D (in) | Cast-in-Place Anchor ³ | | | Post Installed (Adhesive) ^{3, 7, 9} 5/8" Rod with SET-XP™ / SET/ AT | | | Post Installed (Mechanical) ³ 3/4" Dia. x 8 1/2" Titen HD ^{®12} | |
|--|--------------------------|-------------|---|---|---|------------------------------|-------------------------|---|---|-------------------------|--|-------------------------|
| | | | | | Minimum ^{2, 6} End Distance (in) | Anchor ⁸ Assembly | Minimum Stem Width (in) | Minimum ^{2, 6} End Distance (in) | Minimum Embedment Depth - l _e (in) | Minimum Stem Width (in) | Minimum End Distance (in) | Minimum Stem Width (in) |
| SINGLE STORY | | | | | | | | | | | | |
| 8' Nominal Heights | | | | | | | | | | | | |
| 8 | 8 | OMF69-8x8 | 18 | 14 | 4.5 | OMFSL6-18 | 8 | 4.5 | 12 | 8 | 4.5 | 8 |
| | 10 | OMF69-10x8 | | | | | | | | | 6 | |
| | 12 | OMF69-12x8 | | | | | | | | | 7.5 ⁴ | |
| | 16 | OMF69-16x8 | | | | | | | | | 10 | |
| 12 | 8 | OMF69-8x8 | 20 | 14 | 4.5 | OMFSL6-18 | 8 | 6 | 12 | 8 | 7.5 ⁴ | 10 |
| | 10 | OMF69-10x8 | | | | | | | | | 7.5 ⁴ | |
| | 12 | OMF69-12x8 | | | | | | | | | 10 | |
| | 16 | OMF99-16x8 | | | | | | | | | OMFSL9-18 | |
| 9' Nominal Heights | | | | | | | | | | | | |
| 8 | 8 | OMF69-8x9 | 18 | 14 | 4.5 | OMFSL6-18 | 8 | 4.5 | 12 | 8 | 6 | 8 |
| | 10 | OMF69-10x9 | | | | | | | | | 7.5 ⁴ | |
| | 12 | OMF69-12x9 | | | | | | | | | 10 | |
| | 16 | OMF69-16x9 | | | | | | | | | 7.5 ⁵ | |
| 12 | 8 | OMF69-8x9 | 20 | 14 | 4.5 | OMFSL6-18 | 8 | 6 | 12 | 8 | 7.5 ⁴ | 12 |
| | 10 | OMF69-10x9 | | | | | | | | | 7.5 ⁴ | |
| | 12 | OMF69-12x9 | | | | | | | | | 10 | |
| | 16 | OMF99-16x9 | | | | | | | | | OMFSL9-18 | |
| 10' Nominal Heights | | | | | | | | | | | | |
| 8 | 8 | OMF69-8x10 | 18 | 14 | 4.5 | OMFSL6-18 | 8 | 4.5 | 12 | 8 | 6 | 8 |
| | 10 | OMF69-10x10 | | | | | | | | | 4.5 | |
| | 12 | OMF69-12x10 | | | | | | | | | 6 | |
| | 16 | OMF69-16x10 | | | | | | | | | 7.5 ⁴ | |
| 12 | 8 | OMF99-8x10 | 20 | 14 | 4.5 | OMFSL9-18 | 8 | 4.5 | 12 | 8 | 7.5 ⁴ | 10 |
| | 10 | OMF99-10x10 | | | | | | | | | 7.5 ⁴ | |
| | 12 | OMF99-12x10 | | | | | | | | | 10 | |
| | 16 | OMF99-16x10 | | | | | | | | | 7.5 ⁵ | |
| 12' Nominal Heights | | | | | | | | | | | | |
| 8 | 8 | OMF69-8x12 | 18 | 14 | 4.5 | OMFSL6-18 | 8 | 4.5 | 12 | 8 | 7.5 ⁴ | 10 |
| | 10 | OMF69-10x12 | | | | | | | | | 6 | |
| | 12 | OMF69-12x12 | | | | | | | | | 8 | |
| | 16 | OMF69-16x12 | | | | | | | | | 7.5 ⁴ | |
| 12 | 8 | OMF99-8x12 | 20 | 14 | 4.5 | OMFSL9-18 | 8 | 4.5 | 12 | 8 | 7.5 ⁴ | 10 |
| | 10 | OMF99-10x12 | | | | | | | | | 7.5 ⁴ | |
| | 12 | OMF99-12x12 | | | | | | | | | 10 | |
| | 16 | OMF99-16x12 | | | | | | | | | 7.5 ⁵ | |
| 1ST STORY OF 2 STORIES OR 3 STORIES | | | | | | | | | | | | |
| 8' Nominal Heights | | | | | | | | | | | | |
| 8 | 8 | OMF69-8x8 | 22 | 14 | 4.5 | OMFSL6-18 | 8 | 7.5 ⁴ | 12 | 10 | 7.5 ⁵ | 12 |
| | 10 | OMF69-10x8 | | | | | | | | | 6 | |
| | 12 | OMF99-12x8 | | | | | | | | | 8 | |
| | 16 | OMF99-16x8 | | | | | | | | | NS | |
| 12 | 8 | OMF99-8x8 | 26 | 14 | 4.5 | OMFSL9-18 | 8 | 4.5 | 12 | 8 | NS | NS |
| | 10 | OMF99-10x8 | | | | | | | | | 7.5 ⁴ | |
| | 12 | OMF99-12x8 | | | | | | | | | 10 | |
| | 16 | OMF99-16x8 | | | | | | | | | NS | |
| 20 | 8 | OMF1212-8x8 | 30 | 16 | 7.5 ⁴ | OMFSL9-18 | 10 | NS | NS | NS | NS | NS |
| | 10 | OMF99-10x8 | | | | | | | | | NS | |
| | 12 | OMF99-12x8 | | | | | | | | | NS | |
| | 16 | OMF99-16x8 | | | | | | | | | NS | |
| 9' Nominal Heights | | | | | | | | | | | | |
| 8 | 8 | OMF69-8x9 | 22 | 14 | 4.5 | OMFSL6-18 | 8 | 7.5 ⁴ | 12 | 10 | 7.5 ⁵ | 12 |
| | 10 | OMF69-10x9 | | | | | | | | | 4.5 | |
| | 12 | OMF99-12x9 | | | | | | | | | 8 | |
| | 16 | OMF99-16x9 | | | | | | | | | NS | |
| 12 | 8 | OMF99-8x9 | 26 | 14 | 4.5 | OMFSL9-18 | 8 | 4.5 | 12 | 8 | NS | NS |
| | 10 | OMF99-10x9 | | | | | | | | | 7.5 ⁴ | |
| | 12 | OMF99-12x9 | | | | | | | | | 10 | |
| | 16 | OMF99-16x9 | | | | | | | | | NS | |
| 20 | 8 | OMF99-8x9 | 30 | 16 | 7.5 ⁴ | OMFSL9-18 | 10 | NS | NS | NS | NS | NS |
| | 10 | OMF99-10x9 | | | | | | | | | NS | |
| | 12 | OMF99-12x9 | | | | | | | | | NS | |
| | 16 | OMF99-16x9 | | | | | | | | | NS | |
| 10' Nominal Heights | | | | | | | | | | | | |
| 8 | 8 | OMF69-8x10 | 22 | 14 | 4.5 | OMFSL6-18 | 8 | 7.5 ⁴ | 12 | 10 | 7.5 ⁵ | 12 |
| | 10 | OMF69-10x10 | | | | | | | | | 4.5 | |
| | 12 | OMF99-12x10 | | | | | | | | | 8 | |
| | 16 | OMF99-16x10 | | | | | | | | | NS | |
| 12 | 8 | OMF99-8x10 | 26 | 14 | 4.5 | OMFSL9-18 | 8 | 4.5 | 12 | 8 | NS | NS |
| | 10 | OMF99-10x10 | | | | | | | | | 6 | |
| | 12 | OMF99-12x10 | | | | | | | | | NS | |
| | 16 | OMF99-16x10 | | | | | | | | | NS | |
| 20 | 8 | OMF99-8x10 | 30 | 16 | 7.5 ⁵ | OMFSL9-18 | 12 | NS | NS | NS | NS | NS |
| | 10 | OMF99-10x10 | | | | | | | | | 7.5 ⁴ | |
| | 12 | OMF99-12x10 | | | | | | | | | 10 | |
| | 16 | OMF99-16x10 | | | | | | | | | 8 | |

See next page for footnotes

Wall Bracing *Wind Solutions for Stemwall Foundations (Anchorage into Wall)*

| Equivalent Wall Bracing Length (ft) | Nominal Frame Width (ft) | Model No. | Minimum Footing Width, W (in) | Minimum Footing Depth, D (in) | Cast-in-Place Anchor ³ | | | Post Installed (Adhesive) ^{7,9} 5/8" Rod with SET-XP™/ SET/ AT | | | Post Installed (Mechanical) ³ 3/4" Dia. x 8 1/2" Titen HD® | |
|-------------------------------------|--------------------------|---------------|-------------------------------|-------------------------------|---|------------------------------|-----------------------------|--|---|-------------------------|--|-------------------------|
| | | | | | Minimum ^{2, 6} End Distance (in) | Anchor ⁸ Assembly | Minimum Stemwall Width (in) | Minimum ^{2, 6} End Distance (in) | Minimum Embedment Depth - l _e (in) | Minimum Stem Width (in) | Minimum End Distance (in) | Minimum Stem Width (in) |
| 12' Nominal Heights | | | | | | | | | | | | |
| 8 | 8 | OMF69-8x12 | 22 | 14 | 4.5 | OMFSL6-18 | 8 | 7.5 ⁴ | 12 | 10 | 7.5 ⁵ | 12 |
| | 10 | OMF69-10x12 | | | | 8 | | 4.5 | | 8 | | |
| | 12 | OMF99-12x12 | | | 30 | | 16 | | 7.5 | | OMFSL9-18 | 12 |
| | 16 | OMF99-16x12 | | | | 7.5 ⁴ | | 10 | | NS | | |
| 12 | 8 | OMF99-8x12 | 26 | 14 | 4.5 | | OMFSL9-18 | | 8 | | 4.5 | 12 |
| | 10 | OMF99-10x12 | | | | | | | | | | |
| | 12 | OMF99-12x12 | | | | | | | | | | |
| | 16 | OMF99-16x12 | | | | | | | | | | |
| 20 | 8 | OMF129-8x12 | 30 | 16 | 7.5 | OMFSL9-18 | 12 | NS | NS | NS | NS | NS |
| | 10 | OMF129-10x12 | | | | | | | | | | |
| | 12 | OMF1212-12x12 | | | | | | | | | | |
| | 16 | OMF1212-16x12 | | | | | | | | | | |

- See general notes for additional information.
- See foundation details for typical minimum end distances and edge distances.
- Cast-in-place solution requires 1 1/4" minimum edge distance. Post-installed solutions requires 1 1/4" minimum edge distance, and 5/8" dia. ASTM F1554 Gr. 36 or ASTM A36 threaded rods.
- Solution requires 3" minimum edge distance.
- Solution requires 5" minimum edge distance.
- See page 38 for possible wall configuration for required anchorage end and edge distances.
- Simpson Strong-Tie® SET-XP™ anchoring adhesive required for seismic solutions.
- For short stemwalls, see stemwall anchorage to footing solutions.
- For Simpson Strong-Tie® Acrylic-Tie® adhesive solutions, increase embedment depths shown by 4".
- NS = No close-to-edge and end-distance solutions.
- See pages 59–60 for footing and grade-beam size and reinforcing required.

Wall Bracing *Seismic Solutions for Stemwall Foundations (Anchorage into Wall)*

| Equivalent Wall Bracing Length (ft) | Nominal Frame Width (ft) | Model No. | Minimum ¹¹ Footing Width, W (in) | Minimum ¹¹ Footing Depth, D (in) | Cast-in-Place Anchor ³ | | | Post Installed (Adhesive) ^{3, 7, 9} ¾" Rod with SET-XP™/ SET/ AT | | | | | |
|--|--------------------------|---------------|---|---|---|------------------------------|-------------------------|--|---|-------------------------|------------------|----|----|
| | | | | | Minimum ^{2, 6} End Distance (in) | Anchor ² Assembly | Minimum Stem Width (in) | Minimum ^{2, 6} End Distance (in) | Minimum Embedment Depth - l _e (in) | Minimum Stem Width (in) | | | |
| SINGLE STORY | | | | | | | | | | | | | |
| 8' Nominal Heights | | | | | | | | | | | | | |
| 8 | 8 | OMF69-8x8 | 22 | 14 | 4.5 | OMFSL6-18 | 8 | NS | NS | NS | | | |
| | 10 | OMF69-10x8 | | | | | | 4.5 | 12 | 8 | | | |
| | 12 | OMF99-12x8 | | | | | | | | | | | |
| | 16 | OMF99-16x8 | | | | | | | | | | | |
| 12 | 8 | OMF69-8x8 | 24 | 16 | 4.5 | OMFSL6-18 | 8 | NS | NS | NS | | | |
| | 10 | OMF69-10x8 | | | | | | 6 | 12 | 8 | | | |
| | 12 | OMF99-12x8 | | | | | | | | | | | |
| | 16 | OMF99-16x8 | | | | | | | | | | | |
| 9' Nominal Heights | | | | | | | | | | | | | |
| 8 | 8 | OMF69-8x9 | 22 | 14 | 4.5 | OMFSL6-18 | 8 | NS | NS | NS | | | |
| | 10 | OMF69-10x9 | | | | | | 4.5 | 12 | 8 | | | |
| | 12 | OMF99-12x9 | | | | | | | | | | | |
| | 16 | OMF99-16x9 | | | | | | | | | | | |
| 12 | 8 | OMF69-8x9 | 24 | 16 | 4.5 | OMFSL6-18 | 8 | NS | NS | NS | | | |
| | 10 | OMF69-10x9 | | | | | | 6 | 12 | 8 | | | |
| | 12 | OMF99-12x9 | | | | | | | | | | | |
| | 16 | OMF99-16x9 | | | | | | | | | | | |
| 10' Nominal Heights | | | | | | | | | | | | | |
| 8 | 8 | OMF69-8x10 | 22 | 14 | 4.5 | OMFSL6-18 | 8 | NS | NS | NS | | | |
| | 10 | OMF69-10x10 | | | | | | 4.5 | 12 | 8 | | | |
| | 12 | OMF99-12x10 | | | | | | | | | | | |
| | 16 | OMF99-16x10 | | | | | | | | | | | |
| 12 | 8 | OMF69-8x10 | 24 | 16 | 7.5 ⁵ | OMFSL6-19 | 12 | NS | NS | NS | | | |
| | 10 | OMF99-10x10 | | | 4.5 | OMFSL9-18 | 8 | 6 | 12 | 8 | | | |
| | 12 | OMF99-12x10 | | | | | | | | | | | |
| | 16 | OMF912-16x10 | | | | | | | | | | | |
| 12' Nominal Heights | | | | | | | | | | | | | |
| 8 | 8 | OMF69-8x12 | 22 | 14 | 7.5 ⁴ | OMFSL6-18 | 8 | NS | NS | NS | | | |
| | 10 | OMF69-10x12 | | | 4.5 | | | OMFSL9-18 | 10 | 4.5 | 12 | 8 | |
| | 12 | OMF99-12x12 | | | | | | | | | | | |
| | 16 | OMF99-16x12 | | | | | | | | | | | |
| 12 | 8 | OMF99-8x12 | 24 | 16 | 7.5 ⁴ | OMFSL9-18 | 8 | 7.5 ⁴ | 12 | 10 | | | |
| | 10 | OMF99-10x12 | | | 4.5 | | | 6 | | | 8 | | |
| | 12 | OMF99-12x12 | | | | | | | | | | | |
| | 16 | OMF99-16x12 | | | | | | | | | | | |
| 1ST STORY OF 2 STORIES OR 3 STORIES | | | | | | | | | | | | | |
| 8' Nominal Heights | | | | | | | | | | | | | |
| 8 | 8 | OMF99-8x8 | 28 | 16 | 4.5 | OMFSL9-18 | 8 | 7.5 ⁴ | 12 | 10 | | | |
| | 10 | OMF99-10x8 | | | | | | NS | | | NS | NS | |
| | 12 | OMF99-12x8 | | | | | | | | | | | |
| | 16 | OMF99-16x8 | | | | | | | | | | | |
| 12 | 8 | OMF99-8x8 | 32 | 16 | 7.5 ⁵ | OMFSL9-18 | 10 | NS | NS | NS | | | |
| | 10 | OMF99-10x8 | | | 4.5 | | | 7.5 ⁴ | | | 8 | | |
| | 12 | OMF99-12x8 | | | | | | | | | | | |
| | 16 | OMF99-16x8 | | | | | | | | | | | |
| 9' Nominal Heights | | | | | | | | | | | | | |
| 8 | 8 | OMF99-8x9 | 28 | 16 | 4.5 | OMFSL9-18 | 8 | 7.5 ⁴ | 12 | 10 | | | |
| | 10 | OMF99-10x9 | | | | | | NS | | | NS | NS | |
| | 12 | OMF99-12x9 | | | | | | | | | | | |
| | 16 | OMF912-16x9 | | | | | | | | | | | |
| 12 | 8 | OMF99-8x9 | 32 | 16 | 7.5 ⁵ | OMFSL9-18 | 10 | NS | NS | NS | | | |
| | 10 | OMF99-10x9 | | | 4.5 | | | 7.5 ⁴ | | | 8 | | |
| | 12 | OMF99-12x9 | | | | | | | | | | | |
| | 16 | OMF99-16x9 | | | | | | | | | | | |
| 10' Nominal Heights | | | | | | | | | | | | | |
| 8 | 8 | OMF99-8x10 | 28 | 16 | 7.5 ⁴ | OMFSL9-18 | 10 | 7.5 ⁴ | 12 | 10 | | | |
| | 10 | OMF99-10x10 | | | 4.5 | | | | | | 8 | | |
| | 12 | OMF99-12x10 | | | | | | | | | | | |
| | 16 | OMF912-16x10 | | | | | | | | | | | |
| 12 | 8 | OMF99-8x10 | 36 | 16 | 7.5 ⁵ | OMFSL9-18 | 10 | NS | NS | NS | | | |
| | 10 | OMF99-10x10 | | | 4.5 | | | 7.5 ⁴ | | | 8 | | |
| | 12 | OMF99-12x10 | | | | | | | | | | | |
| | 16 | OMF99-16x10 | | | | | | | | | | | |
| 12' Nominal Heights | | | | | | | | | | | | | |
| 8 | 8 | OMF912-8x12 | 28 | 16 | 7.5 ⁵ | OMFSL9-18 | 12 | NS | NS | NS | | | |
| | 10 | OMF99-10x12 | | | 4.5 | | | 8 | | | 7.5 ⁴ | 12 | 10 |
| | 12 | OMF99-12x12 | | | | | | | | | | | |
| | 16 | OMF99-16x12 | | | | | | | | | | | |
| 12 | 8 | OMF99-8x12 | 36 | 16 | 7.5 ⁵ | OMFSL9-18 | 12 | NS | NS | NS | | | |
| | 10 | OMF129-10x12 | | | 4.5 | | | 7.5 ⁴ | | | 10 | | |
| | 12 | OMF129-12x12 | | | | | | | | | | | |
| | 16 | OMF1212-16x12 | | | | | | | | | | | |

- See general notes for additional information.
- See foundation details for typical minimum end distances and edge distances.
- Cast-in-place solution requires 1¼" minimum edge distance. Post-installed solutions requires 1¼" minimum edge distance, and ¾" dia. ASTM F1554 Gr. 36 or ASTM A36 threaded rods.
- Solution requires 3" minimum edge distance.
- Solution requires 5" minimum edge distance.
- See page 38 for possible wall configuration for required anchorage end and edge distances.
- Simpson Strong-Tie® SET-XP™ anchoring adhesive required for seismic solutions.
- For short stemwalls, see stemwall anchorage to footing solutions.
- For Simpson Strong-Tie® Acrylic-Tie® adhesive solutions, increase embedment depths shown by 4".
- NS = No close-to-edge and end-distance solutions.
- See pages 59–60 for footing and grade-beam size and reinforcing required.

Wall Bracing Solutions for Stemwall Foundations (Anchorage into Wall)

| BALLOON FRAMING: Wind Solutions | | | | | | | | | | |
|---|--------------------------|---------------|-------------------------------|-------------------------------|--|------------------------------|-------------------------|--|---|-------------------------|
| Equivalent Wall Bracing Length (ft) | Nominal Frame Width (ft) | Model No. | Minimum Footing Width, W (in) | Minimum Footing Depth, D (in) | Cast-in-Place Anchor ³ | | | Post Installed Solutions | | |
| | | | | | Minimum ^{2,9} End Distance (in) | Anchor ⁶ Assembly | Minimum Stem Width (in) | 5/8" Rod with SET-XP/SET/AT ^{5,7} | | |
| | | | | | | | | Minimum ^{2,9} End Distance (in) | Minimum Embedment Depth - l _e (in) | Minimum Stem Width (in) |
| 18' Nominal Heights | | | | | | | | | | |
| 8 | 8 | OMF99-8x18 | 22 | 14 | 4.5 | OMFSL9-18 | 8 | 4.5 | 12 | 8 |
| | 10 | OMF912-10x18 | | | | | | | | |
| | 12 | OMF912-12x18 | | | | | | | | |
| | 16 | OMF912-16x18 | | | | | | | | |
| 19' Nominal Heights | | | | | | | | | | |
| 8 | 8 | OMF912-8x19 | 22 | 14 | 4.5 | OMFSL9-18 | 8 | 4.5 | 12 | 8 |
| | 10 | OMF912-10x19 | | | | | | | | |
| | 12 | OMF912-12x19 | | | | | | | | |
| | 16 | OMF129-16x19 | | | | | | | | |
| BALLOON FRAMING: Seismic Solutions | | | | | | | | | | |
| 18' Nominal Heights | | | | | | | | | | |
| 8 | 8 | OMF129-8x18 | 32 | 16 | 4.5 | OMFSL9-18 | 8 | 4.5 | 12 | 8 |
| | 10 | OMF129-10x18 | | | | | | | | |
| | 12 | OMF1212-12x18 | | | | | | | | |
| | 16 | OMF1212-16x18 | | | | | | | | |
| 12 | 8 | OMF1512-8x18 | 38 | 16 | 7.5 ⁴ | OMFSL9-18 | 10 | NS | NS | NS |
| | 10 | OMF1512-10x18 | | | | | | 7.5 ⁴ | 12 | 10 |
| | 12 | OMF1512-12-18 | | | | | | | | |
| 19' Nominal Heights | | | | | | | | | | |
| 8 | 8 | OMF129-8x19 | 32 | 16 | 4.5 | OMFSL9-18 | 8 | 4.5 | 12 | 8 |
| | 10 | OMF1212-10x19 | | | | | | | | |
| | 12 | OMF1212-12x19 | | | | | | | | |
| | 16 | OMF1212-16x19 | | | | | | | | |

1. See general notes for additional information.
2. See foundation details for typical minimum end distances and edge distances.
3. Cast-in-place solution requires 1 3/4" minimum edge distance. Post-installed solutions requires 1 3/4" minimum edge distance, and 5/8" dia. A36 threaded rods.
4. Solution requires 3" minimum edge distance.
5. Simpson Strong-Tie® SET-XP™ anchoring adhesive required for seismic solutions.
6. For short stemwalls, see stemwall anchorage into footing solutions.
7. For Simpson Strong-Tie® Acrylic-Tie® adhesive solutions, increase embedment depths shown by 4".
8. NS = No close-to-edge and end-distance solutions.
9. See page 38 for possible wall configuration for required anchorage end and edge distances.
10. See pages 59–60 for footing and grade-beam size and reinforcing required.

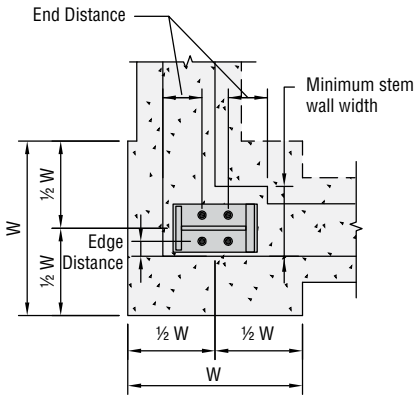

Plan View at Corner

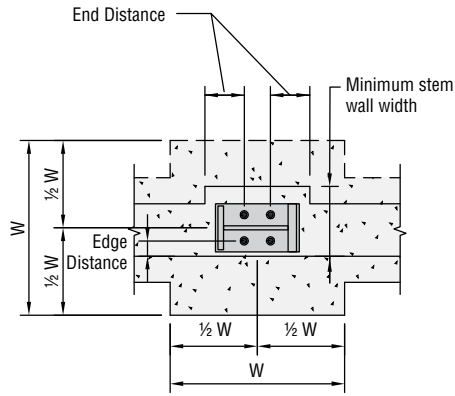

Plan View Away From Corner

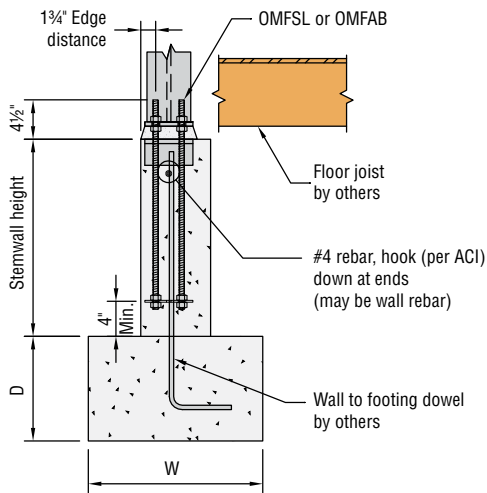

Section View Cast-in-Place Application

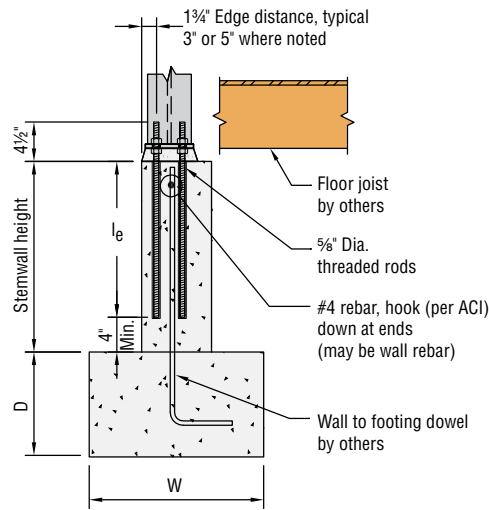

Section View Adhesive Application

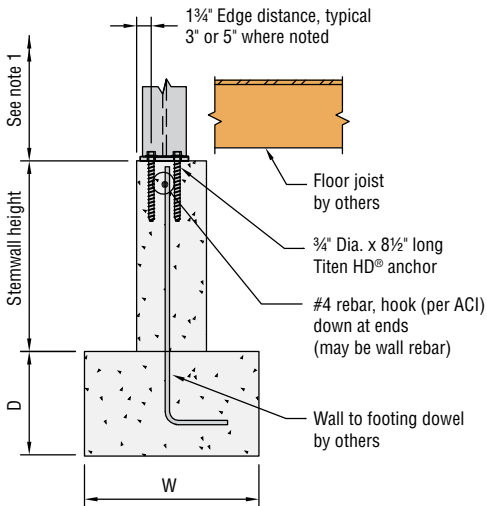

Section View Mechanical Application

Notes:

1. Non-shrink grout is not required for post-installed mechanical applications. However, top-of-concrete to top-of-field installed top plate distance needs to be adjusted to achieve the listed H₁ values in the catalog.
2. See detail 5/SF3 for top of wall adjustment.
3. See detail 6/SF2 for column height adjustment at base.

Note: Place moment frame anchorage before placing rebar.