

Top-Flange Joist Hangers I-Joist and Structural Composite Lumber Hangers

Simpson Strong-Tie offers several top-flange hanger options for attaching joists to the Strong-Frame™ ordinary moment frame.

ITS: The innovative ITS sets a new standard for engineered-wood top-flange hangers. The ITS installs faster and uses fewer nails than any other EWP top-flange hanger. The new Strong-Grip™ seat allows standard joist installation without joist nails resulting in the lowest installed cost.

ITT: The ITT's special bend-tabs constrains the I-joist, helping to reduce squeaks resulting from joist movement. I-joist flange thickness for bend-tab application is 1 1/8" to 1 1/2".

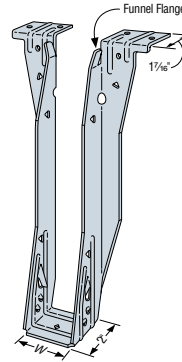

MIT/HIT: These joist hangers feature positive-angle nailing which allows the nail to be driven at approximately 45° into the joist flange. This minimizes splitting of the flanges while permitting time-saving nailing from a better angle.

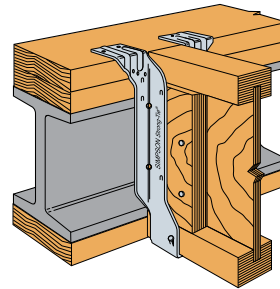

HIT Installation
on a 3x Nailer
mounted
on a Steel Beam

BA: A cost-effective hanger targeted at high-capacity I-joists and common structural composite lumber applications. A min/max joist nail option creates added versatility. The unique two level embossment provides added stiffness to the top flange.

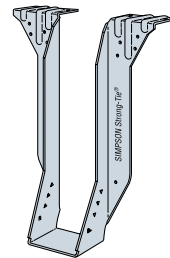

BA
Patent Pending

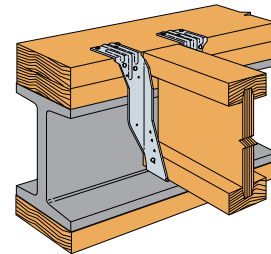

BA installed
2X nailer on steel beam
minimum nailing

LBV, B and HB: The newly improved LBV, B and HB hangers offer wide versatility for I-joists and structural composite lumber. The enhanced load capacity widens the range of applications for these hangers. The LBV features positive angle nailing and does not require the use of web stiffeners for standard non modified I-joist installations.

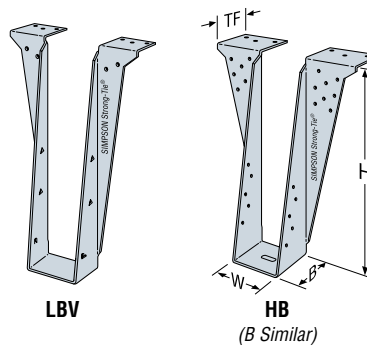

LBV

HB
(B Similar)

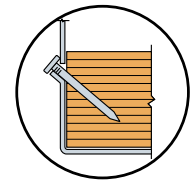

LBV features Positive
Angle Nailing, no web
stiffeners are required

W, WPU, HWU and HW: This series of purlin hangers offer the greatest design flexibility and versatility.

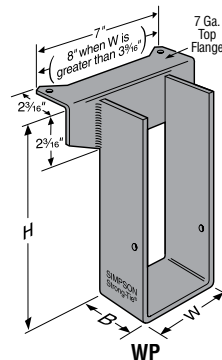

WP

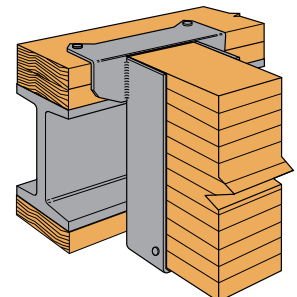

WP Installed

See the Simpson Strong-Tie *Wood Construction Connectors* catalog for complete information and General Notes for these joist hangers.