

REVISED

STHD Built-in tab plus!



The latest version of the STHD Strap Tie Holdown incorporates new features that were added as a result of input from the field. When used in conjunction with the StrapMate® you have a system that prevents both parallel and perpendicular movement relative to the form, allows for accurate location of the STHD's, and reduces the possibility of spalling (and therefore avoids costly retrofits!).



This flier reflects information available as of February 1, 2005. This information is updated periodically; contact Simpson for current information and limited warranty or see www.strongtie.com.

New Features:

- Built-in tab
- StrapMate locator line
- Additional diamond hole on rim joist versions

Benefits:

Built-in Tab:

- Holds STHD away from the formboard
- Reduces spalling and costly retrofits
- Prevents movement of STHD back into the formboards

StrapMate Locator Line:

- Easy inspection to ensure proper location
- Allows adjustment without removing strap

Additional Diamond Hole:

- One more fastener to help prevent the STHDRJ from bowing out at the rim joist section

Home Office
4120 Dublin Blvd., Ste 400
Dublin, CA 94568
FAX: 925/833-1496

Northwest USA
5151 S. Airport Way
Stockton, CA 95206
FAX: 209/234-3868

Southwest USA
260 N. Palm St
Brea, CA 92821
FAX: 714/871-9167

Southeast USA
2221 Country Lane
McKinney, TX 75069
FAX: 972/542-5379

Northeast USA
2600 International St
Columbus, OH 43228
FAX: 614/876-0636

Quik Drive Factory
436 Calvert Drive
Gallatin, TN 37066
FAX: 615/451-9806

Eastern Canada
5 Kenview Blvd.
Brampton, ON L6T 5G5
Canada
FAX: 905/458-7274

Western Canada
11476 Kingston St.
Maple Ridge, BC V2X 0Y5
Canada
FAX: 604/465-0297

Warehouses:
Enfield, CT; Jacksonville, FL;
Kent, WA; Langley, B.C.

SPALLING LOAD REDUCTION!

Bending the strap horizontal 90° during installation may cause spalling behind the strap. If the spall is 1" or less, full loads apply. For spalls between 1" and 4" the allowable load is 0.90 of the table load. Spalls over 4" must be reviewed by a structural engineer.

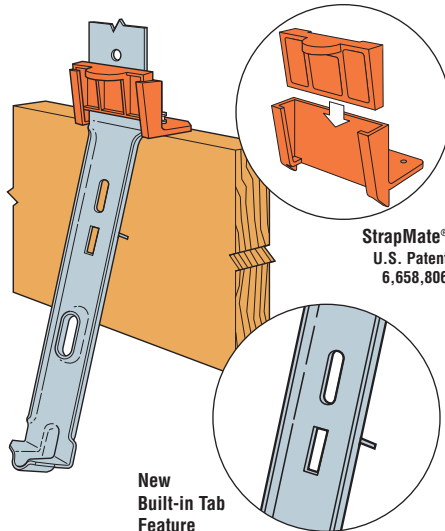
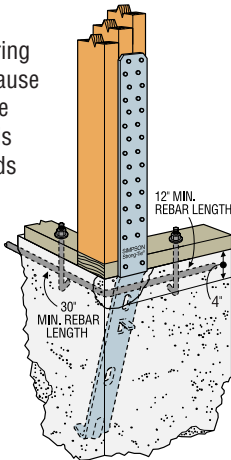

StrapMate®
U.S. Patent
6,658,806

New
Built-in Tab
Feature

800-999-5099
www.strongtie.com

© Copyright 2005
Simpson Strong-Tie Company, Inc.

Printed in the USA

F-STHDTAB05 2/05